



Charles Bainbridge  
Estate Agents



FROM  
THE SUNDAY TIMES  
THE SUNDAY TIMES



FROM  
THE SUNDAY TIMES  
THE SUNDAY TIMES



Everything you need to know about:

28 Castle Road,  
Whitstable,  
Kent, CT5 2DY



Charles Bainbridge Estate Agents

[charlesbainbridge.com](http://charlesbainbridge.com)



# Charles Bainbridge

1 The Bakery, 47 Broad Street  
Canterbury, Kent CT1 2LS

01227 780227

sales@charlesbainbridge.com  
lettings@charlesbainbridge.com

**Charles Bainbridge is a multi-award winning**, progressive, and innovative firm with people at its heart. We pride ourselves on achieving consistent high quality across all sectors, whilst retaining individual and personal client relationships.

We are proud of our reputation for providing genuine and honest advice, delivered with warmth and integrity. As such we are pleased to be chosen to act for a wide range of private clients and are first choice for many corporate clients including solicitors, accountants, developers and investors.

We are proud to have been awarded the top grading of "Exceptional" in the **Best Estate Agent Guide 2018**, an accolade achieved only by the top 5% of estate agents nationally.



We are delighted to have been recognised nationally having scooped two **Sunday Times, Estate Agency of the Year Awards**, in separate categories.



Charles Bainbridge Estate Agents

charlesbainbridge.co.uk

 Introduction

 The Property

 Property Prices

 Local Authority

 Transport Links

Education 

Health 

Local Amenities 

Local Policing 

Census 



### An invaluable insight into **your new home**

This Location Information brochure offers an informed overview of **28 Castle Road** as a potential new home, along with essential material about its surrounding area and its local community. It provides a valuable insight for any prospective owner or tenant.

We wanted to provide you with information that you can absorb quickly, so we have presented it as visually as possible, making use of maps, icons, tables, graphs and charts. Overall, the brochure contains information about:

- **The Property** - including property details, floor plans, room details, photographs and Energy Performance Certificate.
- **Transport** - including locations of bus and coach stops, railway stations and ferry ports.
- **Health** - including locations, contact details and organisational information on the nearest GPs, pharmacies, hospitals and dentists.
- **Local Policing** - including locations, contact details and information about local community policing and the nearest police station, as well as police officers assigned to the area.
- **Education** - including locations of infant, primary and secondary schools and Key Performance Indicators (KPIs) for each key stage.
- **Local Amenities** - including locations of local services and facilities - everything from convenience stores to leisure centres, golf courses, theatres and DIY centres.
- **Census** - We have given a breakdown of the local community's age, employment and educational statistics.





28 CASTLE ROAD, WHITSTABLE £1,400 p/m



**x3**  
Bedrooms



**x2**  
Living Rooms



**x2**  
Bathrooms

Where you are

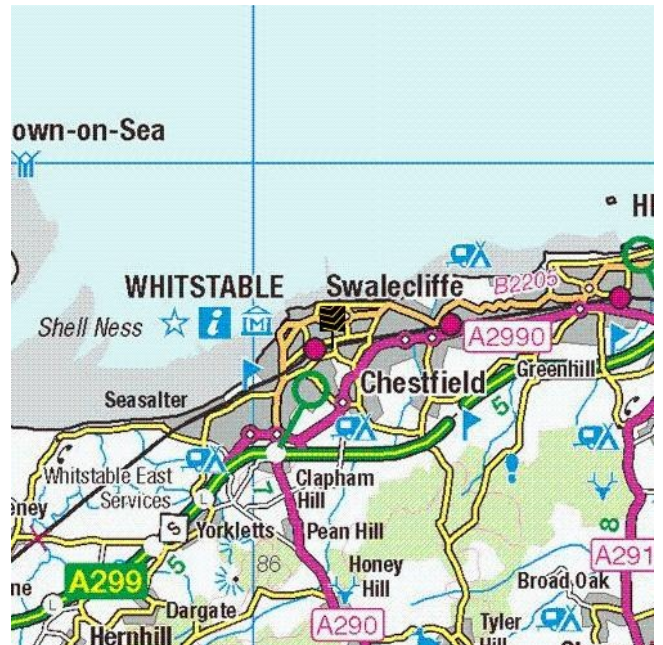





A semi-detached chalet bungalow in a lovely location within walking distance of the seafront and town centre. The property is well presented throughout and is deceptively spacious. The sitting room has a wood burning stove and opens onto the front room and to the rear is an attractively fitted kitchen/breakfast room which overlooks and opens onto the garden. The kitchen is fitted with a range of integral appliances (fridge/freezer, dishwasher, washing machine) and has a space for a tumble dryer. There is a useful extra room currently used as an art room but could also be a study or utility area. There are two bedrooms on the ground floor, the bathroom and a shower room. Upstairs is a spacious master bedroom and eaves storage.

Externally the rear garden is easy to maintain with paving and shingle surrounded by small borders and there is a lovely mature fruit tree. To one side is a private decked area and to the other side a timber shed and pedestrian access through to the front. Private parking is located to the rear with pedestrian access via a gate.

#### **Location**

Whitstable is a very popular seaside town famous for its fishing heritage and particularly oyster fisheries. There is a comprehensive range of shopping facilities in the town, including many independent traders and a wonderful coastline offering opportunities for a range of water-sports. Easy access can be gained onto the A2 to Dover and M2 to London. The Cathedral City of Canterbury is accessible to the south providing a further range of facilities and the High Speed rail link to London.



**Charles Bainbridge** 1 The Bakery 47 Broad Street, Canterbury, CT1 2LS **01227 780227**



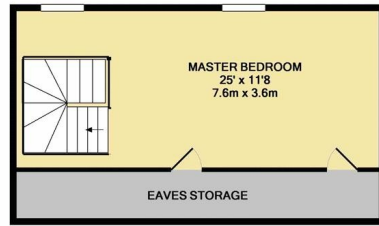
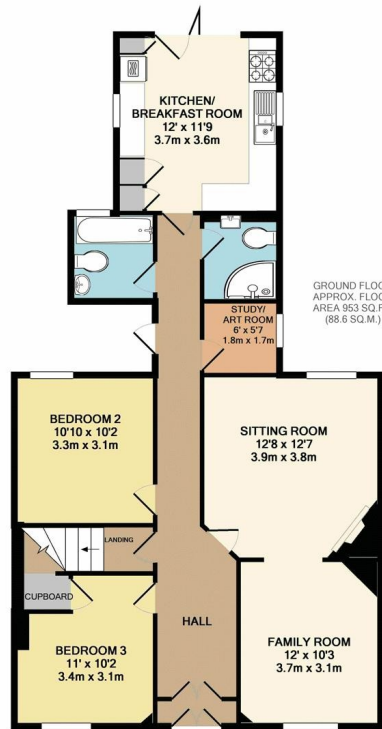

1ST FLOOR  
APPROX. FLOOR  
AREA 410 SQ. FT.  
(38.1 SQ. M.)

TOTAL APPROX. FLOOR AREA 1363 SQ. FT. (126.6 SQ. M.)

Whilst every attempt has been made to ensure the accuracy of the floor plan contained here, measurements of doors, windows, rooms and any other items are approximate and no responsibility is taken for any error, omission, or mis-statement. This plan is for illustrative purposes only and should be used as such by any prospective purchaser. The services, systems and appliances shown have not been tested and no guarantee as to their operability or efficiency can be given.  
Made with Metopix ©2019



**Charles Bainbridge 1 The Bakery 47 Broad Street, Canterbury, CT1 2LS 01227 780227**

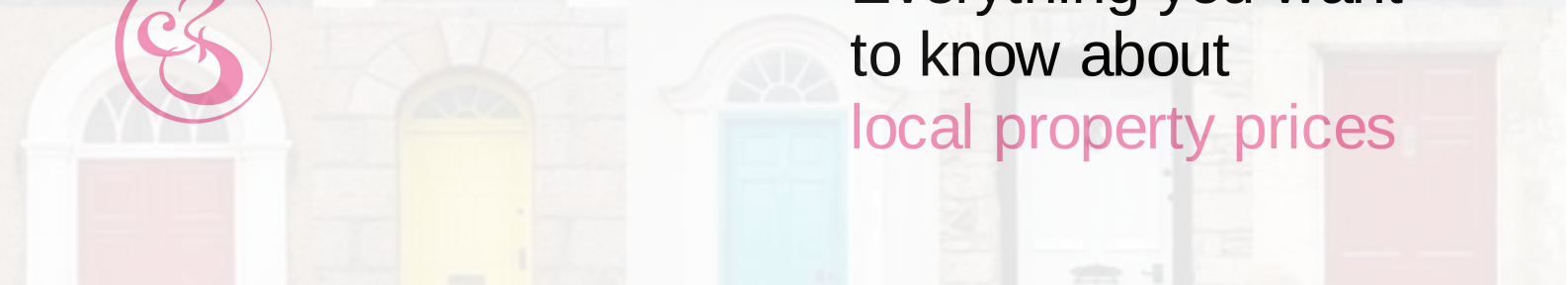

Everything you want  
to know about  
local property prices

## How does **Castle Road** compare to the **county** and **national average**?

Whether you are selling, buying, letting or renting it is always useful to know the prices that local properties have recently sold for. The table below contains local, average and national sold prices for the period 1/7/2016 to 31/1/2017 for all types of property allowing you to get a sense of the current market conditions.

Post code / County / National	Detached	Semi-detached	Terraced	Flats/Maisonettes
<b>CT5</b>	£451307	£308109	£323406	£209739
<b>Kent</b>	£493329	£309045	£254112	£182678
<b>National</b>	£388720	£242324	£232459	£275086

Data produced by Land Registry © Crown copyright 2014.

This data covers the transactions received at Land Registry in the period 1/1/2010 to 31/1/2017. © Crown copyright 2014.

## What prices have properties sold for in **Castle Road**?

If you know the sold price of other properties in the same road, you will get a much better idea of how much your prospective new home could be worth. We have collated this information for you in the table below. It shows the address, sold price, and property type for all properties recently sold in **Castle Road**.

Address	Type	Tenure	Price	DOT
14, CASTLE ROAD, WHITSTABLE, KENT, CT5 2DX	Detached	Freehold	£622000	2016-07-22
6, CASTLE ROAD, WHITSTABLE, KENT, CT5 2DX	Detached	Freehold	£271833	2016-06-02
13, CASTLE ROAD, WHITSTABLE, KENT, CT5 2DX	Detached	Freehold	£450000	2016-01-15
66, CASTLE ROAD, WHITSTABLE, KENT, CT5 2EA	Detached	Freehold	£475000	2015-11-23
28, CASTLE ROAD, WHITSTABLE, KENT, CT5 2DY	Semi-Detached	Freehold	£420000	2015-05-22
CARLTON COURT, 17, CASTLE ROAD, WHITSTABLE, KENT, CT5 1FN	Flats/Maisonettes	Leasehold	£247500	2015-02-06
73, CASTLE ROAD, WHITSTABLE, KENT, CT5 1SR	Flats/Maisonettes	Leasehold	£155000	2014-03-28
59, CASTLE ROAD, WHITSTABLE, KENT, CT5 2ED	Detached	Freehold	£470000	2014-01-06
63, CASTLE ROAD, WHITSTABLE, KENT, CT5 1SR	Flats/Maisonettes	Leasehold	£145000	2013-09-26
CARLTON COURT, 19, CASTLE ROAD, WHITSTABLE, KENT, CT5 1FN	Flats/Maisonettes	Leasehold	£219000	2013-08-14

Data produced by Land Registry © Crown copyright 2014.

This data covers the transactions received at Land Registry in the period 1/1/2010 to 31/1/2017. © Crown copyright 2014.



**Charles Bainbridge** 1 The Bakery 47 Broad Street, Canterbury, CT1 2LS **01227 780227**



Everything you want  
to know about  
local authorities



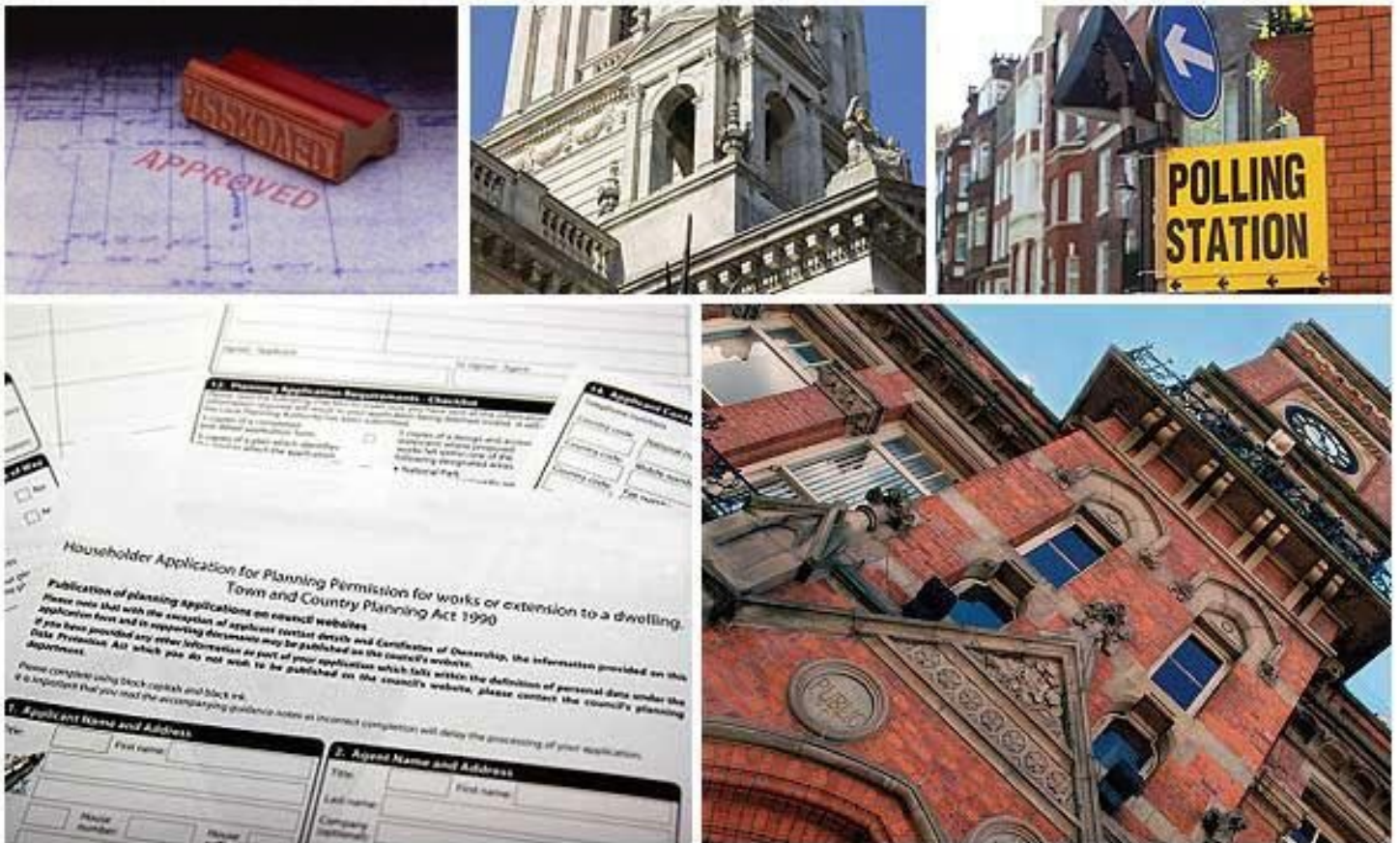

**Get to know your local authorities**

Local government directly affects quality of life, particularly when it comes to council tax, planning, waste disposal and the impact of local policies. You may want to investigate how this is likely to affect you if you decide to move. There are nearly 400 local authorities in England, with five different types of local government structure. These can be broadly divided into **single-tier** and **two-tier authorities**. Single-tier authorities are **Metropolitan Authorities, London Boroughs** and **Unitary or Shire Authorities**. Two-tier authorities have both a **County Council**, and a **District Council or City Council**. There are also around 10,000 parish and town councils, effectively creating an additional tier in some areas - mostly, but not exclusively, in rural areas. The National Association of Local Councils (NALC) represents and works on behalf of these community councils and is a useful contact point.

The local authority locations and contact details for **28 Castle Road** are:

Shire / County / District	Website	Address	Contact details
Canterbury City Council (Shire District)	<a href="http://www.canterbury.gov.uk">http://www.canterbury.gov.uk</a>	Military Road, Canterbury, Kent, CT1 1YW	t: 01227 862006 f: 01227 862020 e: customer.services@canterbury.gov.uk
Kent County Council (Shire County)	<a href="http://www.kent.gov.uk">http://www.kent.gov.uk</a>	Maidstone, Kent, ME14 1XQ	t: 0845 8247247 f: 01622 759905 e: county.hall@kent.gov.uk

**Disclaimer:** The information displayed above has been obtained using the property's postcode in proximity to its local authority. It is recommended that this information is independently verified.



Everything you want  
to know about  
transport links





Become familiar with **public transport links**

Being able to choose to travel by public transport is important for many reasons. It helps to reduce congestion, provides access to work and education, and facilitates use of health and leisure facilities. If you or your family members travel abroad, access to the nearest ferry terminals is also likely to be a significant factor in choosing a new property. Using the maps below, you can pinpoint the precise locations of transport links for **28 Castle Road**. Tables for each type of transport indicate the property's distance from the nearest bus stops, railway stations, coach stops and ferry terminals (providing that these facilities are within the scale proximity of the maps.)

Transport Links

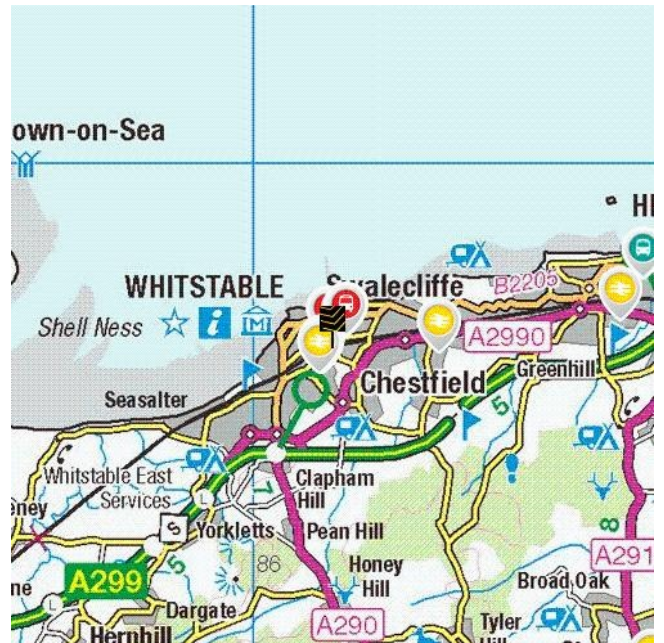

	Airports	Approx Distance
	London Southend Airport	20.36 miles
	Lydd London Ashford Airport	28.41 miles
	Biggin Hill Airport	43.34 miles
	London City Airport	43.65 miles
	London Stansted Airport	49.46 miles
	Ferry ports	Approx Distance
	Ramsgate Ferry Terminal	16.41 miles
	Folkestone Eurotunnel Terminal	18.58 miles
	Burnham on Crouch Ferry Landing	20.47 miles
	Dover Eastern Docks Ferry Terminal	20.48 miles
	Dover Western Docks Ferry Terminal	20.69 miles
	Wallasea Island Ferry Landing	20.88 miles
	Gravesend Pier	29.41 miles
	Tilbury Ferry Terminal	29.57 miles

**Disclaimer:** The information represented in this section has been sourced from the Department of Transport's Open Data and is based on the property's postcode. It is recommended that this information is independently verified.



**Charles Bainbridge** 1 The Bakery 47 Broad Street, Canterbury, CT1 2LS **01227 780227**



	Train Stations	Approx Distance
	Whitstable Rail Station	0.29 miles
	Chestfield & Swalecliffe Rail Station	1.28 miles
	Herne Bay Rail Station	3.47 miles
	Sturry Rail Station	5.52 miles
	Canterbury West Rail Station	5.54 miles
	Canterbury East Rail Station	6.21 miles
	Selling Rail Station	7.12 miles
	Faversham Rail Station	7.17 miles
	Bus Stops	Approx Distance
	Telephone Exchange	0.16 miles
	Telephone Exchange	0.17 miles
	Railway Station	0.22 miles
	Railway Station	0.24 miles
	Tankerton Circus	0.25 miles
	Tankerton Circus	0.26 miles
	Railway Station	0.27 miles
	Whitstable Rail Station	0.27 miles
	Coach Stops	Approx Distance
	Whitstable: Rail Station Coach Stop	0.22 miles
	Herne Bay: Town Centre Coach Stop	3.84 miles
	Canterbury: Kent Uni. Keynes Coll. Coach Stop	4.67 miles
	Canterbury Bus Station	6.14 miles
	Canterbury: Park & Ride New Dover Rd Coach Stop	7.38 miles
	Birchington: The Square Coach Stop	11.67 miles
	Westgate-on-Sea Coach Stop	13.0 miles
	Margate: Town Centre Coach Stops	14.93 miles

**Disclaimer:** The information represented in this section has been sourced from the Department of Transport's Open Data and is based on the property's postcode. It is recommended that this information is independently verified.





Everything you want  
to know about  
local schools



**How are local schools performing?**

If schools are important to you, then this section sets out the published Key Performance Indicators for schools near to your prospective new home. Key Performance Indicators look primarily at how well pupils perform in their tests and examinations, as well as some other measures like attendance.

If you want to know more about a particular school or college, you can also visit the Ofsted website <http://www.ofsted.gov.uk/inspection-reports/find-inspection-report>

**Local Schools**

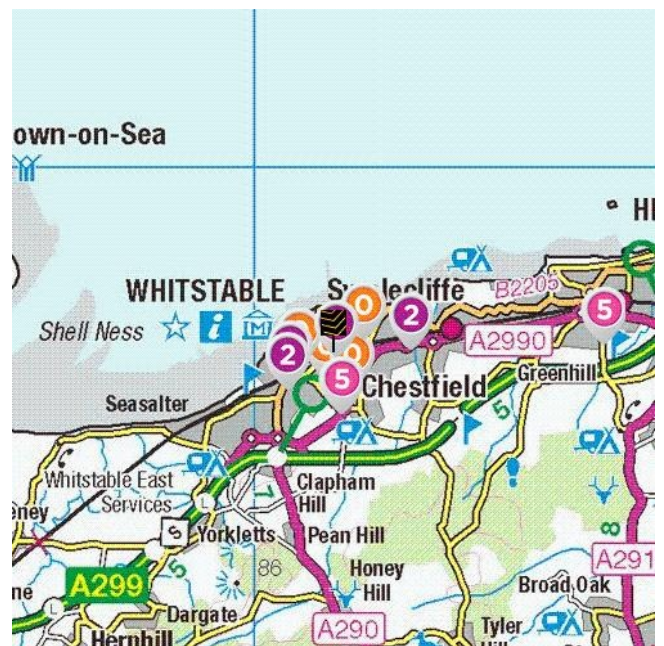
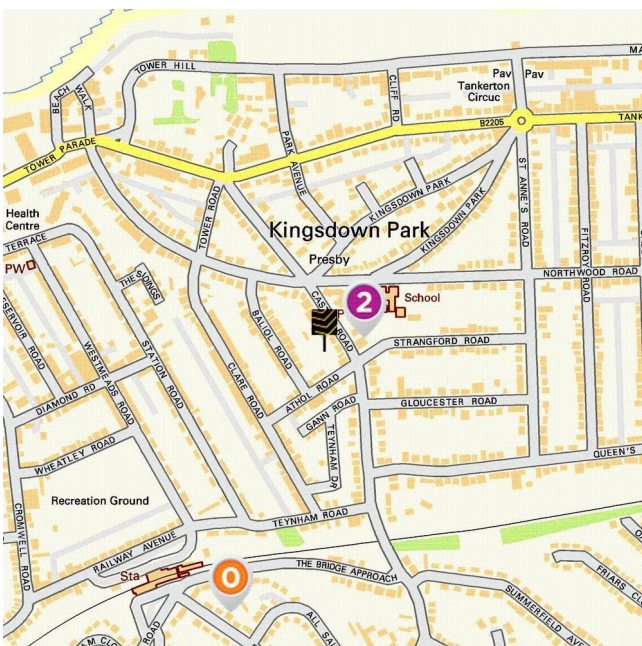

The next page shows tables and charts divided into Key Stages and a list of respective schools local to **28 Castle Road**. There are four main age-related Key Stages defined as:



Special schools are marked with this icon

Key Stage	Definition
Key Stage 0	Marker / indicator - no legal definition
Key Stage 1	Fits broadly with the first stage of education, i.e. ages 5-7.
Key Stage 2	Fits the later stage of primary education, often known as junior schools, i.e. ages 8-11. This takes pupils up to the standardised break at age 11 after which pupils generally change schools and transfer to secondary education.
Key Stage 3	Secondary education split between key stages 3 and 4, with key stage 3 covering ages 11-13.
Key Stage 4	Key Stage 4 (ages 14-16) covers the two year period of study for GCSE level examinations.
Key Stage 5	Beyond key stage 4 is 16+ or Sixth Form provision, sometimes unofficially referred to as Key Stage 5.

	Key Stage 0 - Name and Address	Approx Distance
	<p><b>Name:</b> Choochoos Day Nursery  <b>Address:</b> The Railway Station, WHITSTABLE, Kent, CT5 1RB</p>	0.26 miles
	<p><b>Name:</b> All Saints Nursery School  <b>Address:</b> Shirley Hall, WHITSTABLE, Kent, CT5 1PG</p>	0.41 miles
	<p><b>Name:</b> Kindergarten Kids Ltd  <b>Address:</b> 102 Albert Street, WHITSTABLE, Kent, CT5 1HT</p>	0.42 miles
	<p><b>Name:</b> Tankerton Bay Nursery School  <b>Address:</b> 1 Graystone Road, WHITSTABLE, Kent, CT5 2JZ</p>	0.44 miles

**Disclaimer:** The information represented in this section has been sourced from Experian and is based on the property's postcode.



**Charles Bainbridge** 1 The Bakery 47 Broad Street, Canterbury, CT1 2LS **01227 780227**

	Key Stage 2 - Information	Approx Distance
	<p><b>Name:</b> St Mary's Catholic Primary School - Whitstable</p> <p><b>Address:</b> Northwood Road, Whitstable, CT5 2EY</p> <p><b>Contact Number:</b> 01222 7272692</p> <p><b>Age Range:</b> 4-11 yrs</p> <p><b>Local Education Authority:</b> Kent</p> <p><b>Religious Character:</b> Roman Catholic</p>	0.04 miles
	<p><b>Name:</b> Whitstable and Seasalter Endowed Church of England Junior School</p> <p><b>Address:</b> High Street, Whitstable, CT5 1AY</p> <p><b>Contact Number:</b> 01222 7273630</p> <p><b>Age Range:</b> 7-11 yrs</p> <p><b>Local Education Authority:</b> Kent</p> <p><b>Religious Character:</b> Church of England</p>	0.57 miles
	<p><b>Name:</b> Whitstable Junior School</p> <p><b>Address:</b> Oxford Street, Whitstable, CT5 1DB</p> <p><b>Contact Number:</b> 01222 7272385</p> <p><b>Age Range:</b> 7-11 yrs</p> <p><b>Local Education Authority:</b> Kent</p> <p><b>Religious Character:</b> Does not apply</p>	0.65 miles
	<p><b>Name:</b> Swalecliffe Community Primary School</p> <p><b>Address:</b> Bridgefield Road, Whitstable, CT5 2PH</p> <p><b>Contact Number:</b> 01222 7272101</p> <p><b>Age Range:</b> 4-11 yrs</p> <p><b>Local Education Authority:</b> Kent</p> <p><b>Religious Character:</b> Does not apply</p>	0.93 miles

**Disclaimer:** The information represented in this section has been sourced from the Department of Education's 2017 results data set and is based on the property's postcode.



## Reading, Writing and Maths

	Name	Expected	Higher
	St Mary's Catholic Primary School - Whitstable	77.0 %	8.0 %
	Whitstable and Seasalter Endowed Church of England Junior School	77.0 %	10.0 %
	Whitstable Junior School	64.0 %	3.0 %
	Swalecliffe Community Primary School	62.0 %	3.0 %
	<b>Kent</b>	<b>59.0 %</b>	<b>6.0 %</b>
	<b>National</b>	<b>53.0 %</b>	<b>5.0 %</b>

## Primary Progress Measures

As well as actual pupil performance in tests and exams an important Key Performance Indicator is that of progress measures that compare the actual achievements of other pupils nationally with similar prior attainment. Any increase in attainment achieved by each pupil will be reflected in the schools progress scores. They are fairer to schools in challenging circumstances, as they recognise a school that is doing a good job with an intake with poor prior attainment.

## Progress Measures for 2017

	Name	Progress Measures 2017		
	St Mary's Catholic Primary School - Whitstable	<b>Maths</b> PM 1.9 Lower 0.5 Upper 3.3	<b>Reading</b> PM 1.9 Lower 3.5 Upper N/A	<b>Writing</b> PM -0.7 Lower -2.2 Upper 0.8
	Whitstable and Seasalter Endowed Church of England Junior School	<b>Maths</b> PM 4.0 Lower 2.4 Upper 5.6	<b>Reading</b> PM 3.8 Lower 5.5 Upper N/A	<b>Writing</b> PM 1.3 Lower -0.4 Upper 3.0
	Whitstable Junior School	<b>Maths</b> PM 0.1 Lower -1.3 Upper 1.5	<b>Reading</b> PM 1.4 Lower 2.9 Upper N/A	<b>Writing</b> PM 1.4 Lower -0.1 Upper 2.9
	Swalecliffe Community Primary School	<b>Maths</b> PM -0.6 Lower -1.8 Upper 0.6	<b>Reading</b> PM 0.1 Lower 1.4 Upper N/A	<b>Writing</b> PM 0.2 Lower -1.1 Upper 1.5

**Disclaimer:** The information represented in this section has been sourced from the Department of Education's 2017 results data set and is based on the property's postcode.



	Key Stage 4 - Information	Approx Distance
	<p><b>Name:</b> The Community College Whitstable  <b>Address:</b> Bellevue Road, Whitstable, CT5 1PX  <b>Contact Number:</b> 01222 7272362  <b>Age Range:</b> 11-18 yrs  <b>Local Education Authority:</b> Kent  <b>Religious Character:</b> Does not apply</p>	0.67 miles
	<p><b>Name:</b> Herne Bay High School  <b>Address:</b> Bullockstone Road, Herne Bay, CT6 7NS  <b>Contact Number:</b> 01222 7361221  <b>Age Range:</b> 11-18 yrs  <b>Local Education Authority:</b> Kent  <b>Religious Character:</b> None</p>	3.24 miles
	<p><b>Name:</b> Kent College (Canterbury)  <b>Address:</b> Whitstable Road, Canterbury, CT2 9DT  <b>Contact Number:</b> 01222 7763231  <b>Age Range:</b> 11-18 yrs  <b>Local Education Authority:</b> Kent  <b>Religious Character:</b> Methodist  <b>Admission Policy:</b> Not applicable</p>	4.72 miles
	<p><b>Name:</b> Kent College International Study Centre  <b>Address:</b> Whitstable Road, Canterbury, CT2 9DT  <b>Contact Number:</b> 01222 7763231  <b>Age Range:</b> 11-18 yrs  <b>Local Education Authority:</b> Kent  <b>Religious Character:</b> None</p>	4.72 miles

**Disclaimer:** The information represented in this section has been sourced from the Department of Education's 2017 results data set and is based on the property's postcode.



### Percentage of pupils achieving 5+ A\*-C/9-4 or equivalents including 9-4 in both English and mathematics GCSEs

	Name	2017	2016	2015	2014
	The Community College Whitstable	39.0 %	35.0 %	28.0 %	39.0 %
	Herne Bay High School	47.0 %	49.0 %	37.0 %	43.0 %
	Kent College (Canterbury)	0.0 %	0.0 %	3.0 %	1.0 %
	Kent College International Study Centre	0.0 %	0.0 %	0.0 %	0.0 %
	<b>Kent</b>	<b>59.9 %</b>	<b>59.0 %</b>	<b>57.4 %</b>	<b>58.1 %</b>
	<b>National</b>	<b>56.6 %</b>	<b>53.5 %</b>	<b>53.8 %</b>	<b>53.4 %</b>

**Disclaimer:** The information represented in this section has been sourced from the Department of Education's 2017 results data set and is based on the property's postcode.

### Average number of GCSE entries per pupil

	Name	Number
	The Community College Whitstable	8.5
	Herne Bay High School	7.8
	Kent College (Canterbury)	7.4
	Kent College International Study Centre	3.6
	<b>Kent</b>	<b>8.5</b>
	<b>National</b>	<b>8.2</b>

**Disclaimer:** The information represented in this section has been sourced from the Department of Education's 2017 results data set and is based on the property's postcode.



**Charles Bainbridge** 1 The Bakery 47 Broad Street, Canterbury, CT1 2LS **01227 780227**



	Key Stage 5 - Information	Approx Distance
	<p><b>Name:</b> The Community College Whitstable</p> <p><b>Address:</b> Bellevue Road, Whitstable, CT5 1PX</p> <p><b>Contact Number:</b> 0122 7272362</p> <p><b>Age Range:</b> 11-18 yrs</p> <p><b>Local Education Authority:</b> Kent</p> <p><b>Religious Character:</b> Does not apply</p>	0.67 miles
	<p><b>Name:</b> The Community College Whitstable</p> <p><b>Address:</b> Bellevue Road, Whitstable, CT5 1PX</p> <p><b>Contact Number:</b> 0122 7272362</p> <p><b>Age Range:</b> 11-18 yrs</p> <p><b>Local Education Authority:</b> Kent</p> <p><b>Religious Character:</b> Does not apply</p>	0.67 miles
	<p><b>Name:</b> Herne Bay High School</p> <p><b>Address:</b> Bullockstone Road, Herne Bay, CT6 7NS</p> <p><b>Contact Number:</b> 0122 7361221</p> <p><b>Age Range:</b> 11-18 yrs</p> <p><b>Local Education Authority:</b> Kent</p> <p><b>Religious Character:</b> None</p>	3.24 miles
	<p><b>Name:</b> Kent College (Canterbury)</p> <p><b>Address:</b> Whitstable Road, Canterbury, CT2 9DT</p> <p><b>Contact Number:</b> 0122 7763231</p> <p><b>Age Range:</b> 11-18 yrs</p> <p><b>Local Education Authority:</b> Kent</p> <p><b>Religious Character:</b> Methodist</p> <p><b>Admission Policy:</b> Not applicable</p>	4.72 miles

**Disclaimer:** The information represented in this section has been sourced from the Department of Education's 2017 results data set and is based on the property's postcode.



### Percentage of A level students achieving at least three levels at grades AAB or better, at least two of which are in facilitating subjects

	Name	%
	The Community College Whitstable	N/A
	The Community College Whitstable	N/A
	Herne Bay High School	2.3 %
	Kent College (Canterbury)	41.9 %
	<b>Kent</b>	<b>15.3 %</b>
	<b>National</b>	<b>17.0 %</b>

**Disclaimer:** The information represented in this section has been sourced from the Department of Education's 2017 results data set and is based on the property's postcode.

As well as actual pupil performance in tests and exams, an important Key Performance Indicator is that of Value Added. When pupils start a school, they all have varying levels of ability and social advantage. A school's Value Added score measures how much progress they have made from the beginning to the end of their compulsory secondary education (i.e. between the end of Key Stage 2 and the end of Key Stage 4). It is a quick measurement of the effect of a school on its pupils.

	Name	Value Added
	The Community College Whitstable	-0.3
	The Community College Whitstable	N/A
	Herne Bay High School	0.0
	Kent College (Canterbury)	0.3



**Charles Bainbridge** 1 The Bakery 47 Broad Street, Canterbury, CT1 2LS **01227 780227**



Everything you want  
to know about  
local health services





**How local are the health services?**

We all want good access to local health facilities, wherever we live. To see how well **28 Castle Road** is served, we have set out below the exact locations of hospitals, Accident & Emergency centres, GPs, pharmacies, dentists, out-of-hours medical care and walk-in clinics. Where it's available, you will find more detailed information, including the names of practitioners and their contact details.

Hospitals		Approx Distance
	KentAnd Canterbury Hospital, Kent and CanterburyHospital, Canterbury, Kent, CT1 3NG	6.86 miles
A&E		Approx Distance
	Queen Elizabeth The Queen Mother Hospital, Queen Elizabeth The Queen Mother Hospital, Margate, Kent, CT9 4AN	15.22 miles
Walk-in Clinics		Approx Distance
	KentAnd Canterbury Hospital, Kent and CanterburyHospital, Canterbury, Kent, CT1 3NG	6.86 miles

**Disclaimer:** The information represented in this section has been sourced from the Department of Health's Open Data and is based on the property's postcode.

	GPs	Approx Distance
	DR JM RIBCHESTER & PARTNERS, WHITSTABLE HEALTH CENTRE, KENT, CT5 1BZ	0.34 miles
	SADDLETON ROAD SURGERY, 32 SADDLETON ROAD, KENT, CT5 4JQ	0.87 miles
	ST ANNES GROUP PRACTICE, ST.ANNE'S GROUP PRACTICE, KENT, CT6 5NF	3.68 miles
	THE PARK SURGERY, THE PARK SURGERY, KENT, CT6 5RE	3.83 miles

**Disclaimer:** The information represented in this section has been sourced from the Department of Health's Open Data and is based on the property's postcode.

	Dental Surgeons	Approx Distance
	C Lewns - Implant & Dental Centre, 166A Cromwell Road, WHITSTABLE, Kent, CT5 1NA	0.33 miles
	Whitstable Dental Centre, 66A Oxford Street, WHITSTABLE, Kent, CT5 1DG	0.67 miles
	Kelvin House Dental Practice, 2 Nelson Road, WHITSTABLE, Kent, CT5 1DP	0.71 miles
	Swalecliffe Dental Centre, 90 Herne Bay Road, WHITSTABLE, Kent, CT5 2LX	1.23 miles
	M Osbourne, 41 Chestfield Road, WHITSTABLE, Kent, CT5 3LD	1.24 miles

**Disclaimer:** The information represented in this section has been sourced from Experian and is based on the property's postcode.



**Charles Bainbridge** 1 The Bakery 47 Broad Street, Canterbury, CT1 2LS **01227 780227**



Everything you want  
to know about  
local amenities





**What about local amenities?**

There are a number of local amenities on offer in the area around **28 Castle Road**. The tables below give the addresses of local shops, restaurants, pubs, gyms and even golf clubs.

	Local Grocers and Convenience Stores	Approx Distance
	Premium Mini Market, 112-114 Tankerton Road, WHITSTABLE, Kent, CT5 2AJ	0.31 miles
	M & P Fruiterers, 134 Tankerton Road, WHITSTABLE, Kent, CT5 2AN	0.35 miles
	Staines Farm Shop, 61 High Street, WHITSTABLE, Kent, CT5 1AP	0.57 miles
	Granny Smiths, 91 High Street, WHITSTABLE, Kent, CT5 1AY	0.57 miles
	The Co-operative Food, Faversham Road, WHITSTABLE, Kent, CT5 4AX	1.95 miles
	Supermarkets	Approx Distance
	Tesco Express, 141 Tankerton Road, WHITSTABLE, Kent, CT5 2AW	0.39 miles
	Budgens Stores Ltd, 44-48 High Street, WHITSTABLE, Kent, CT5 1BQ	0.58 miles
	The Co-operative Food, 58-60 Oxford Street, WHITSTABLE, Kent, CT5 1DG	0.67 miles
	The Co-operative Food, 14-16 Canterbury Road, WHITSTABLE, Kent, CT5 4EX	0.7 miles
	Sainsbury's Supermarkets Ltd, Reeves Way, WHITSTABLE, Kent, CT5 3QS	1.06 miles

**Disclaimer:** The information represented in this section has been sourced from Experian and is based on the property/s postcode.

	Nightclubs	Approx Distance
	The Front, 55 Central Parade, HERNE BAY, Kent, CT6 5JG	3.98 miles
	Vivid Nightclub, 153A High Street, HERNE BAY, Kent, CT6 5AQ	4.06 miles
	Steinbeck and Shaw, St George's Place, CANTERBURY, Kent, CT1 2JT	6.03 miles
	Club Chemistry, 15 Station Road East, CANTERBURY, Kent, CT1 2RB	6.19 miles
	Layzell's, The Broadway, SHEERNESS, Kent, ME12 2DF	11.46 miles
	Pubs / Bars / Inns	Approx Distance
	The Monument, 32 Church Street, WHITSTABLE, Kent, CT5 1PH	0.33 miles
	The New Inn - Shepherd Neame Pubs, 30 Woodlawn Street, WHITSTABLE, Kent, CT5 1HG	0.48 miles
	Quayside - Brakspear Pubs, 67 Harbour Street, WHITSTABLE, Kent, CT5 1AG	0.52 miles
	The Duke - Shepherd Neame Pubs, High Street, WHITSTABLE, Kent, CT5 1AP	0.57 miles
	Ship Centurion, 111 High Street, WHITSTABLE, Kent, CT5 1AY	0.57 miles
	Wine Bars	Approx Distance
	Deco 5, 15-17 Oxford Street, WHITSTABLE, Kent, CT5 1DB	0.65 miles
	Bramley's, 15 Orange Street, CANTERBURY, Kent, CT1 2JA	5.85 miles
	Alberry's Wine Bar, 38 St Margarets Street, CANTERBURY, Kent, CT1 2TY	6.02 miles
	Lime's Lounge, 13 Rosemary Lane, CANTERBURY, Kent, CT1 2PN	6.05 miles
	Christies, 1 Station Approach, BIRCHINGTON, Kent, CT7 9RD	11.47 miles
	Restaurants	Approx Distance
	China Chef, 79 Tankerton Road, WHITSTABLE, Kent, CT5 2AH	0.26 miles
	The Lounge Restaurant & Bar, 1-3 St Annes Road, WHITSTABLE, Kent, CT5 2DN	0.29 miles
	East Coast Dining Room, 101 Tankerton Road, WHITSTABLE, Kent, CT5 2AJ	0.31 miles
	Yantze, 144 Tankerton Road, WHITSTABLE, Kent, CT5 2AN	0.35 miles
	Crab & Winkle, South Quay, WHITSTABLE, Kent, CT5 1AB	0.44 miles
	Golf Club / Courses / Professionals	Approx Distance
	Seasalter Golf Club Ltd, Collingwood Road, WHITSTABLE, Kent, CT5 1EB	0.73 miles
	Boughton Golf Club, Brickfield Lane, FAVERSHAM, Kent, ME13 9AJ	6.18 miles
	Canterbury Golf Club, Scotland Hills, CANTERBURY, Kent, CT1 1TW	6.53 miles
	Faversham Golf Club Ltd, Belmont Park, FAVERSHAM, Kent, ME13 0HB	9.76 miles
	Sheerness Golf Club, Powerstation Road, SHEERNESS, Kent, ME12 3AE	11.86 miles

**Disclaimer:** The information represented in this section has been sourced from Experian and is based on the property's postcode.





Places of Worship		Approx Distance
	Our Lady Immaculate Rc Church, 15A Castle Road, WHITSTABLE, Kent, CT5 2DY	0.0 miles
	The Vocations Centre, Northwood Road, WHITSTABLE, Kent, CT5 2EY	0.04 miles
	All Saints Church, Church Street, WHITSTABLE, Kent, CT5 1PG	0.41 miles
	Hamilton Road Evangelical Church, Hamilton Road, WHITSTABLE, Kent, CT5 1JX	0.42 miles
	Jehovahs Witnesses, 51-52 Albert Street, WHITSTABLE, Kent, CT5 1HT	0.42 miles
Banks / Financial Institutions		Approx Distance
	Natwest, PO Box 68, WHITSTABLE, Kent, CT5 1JY	0.18 miles
	Barclays Bank Plc, East Kent Group, WHITSTABLE, Kent, CT5 2AN	0.35 miles
	Natwest, 132 Tankerton Road, WHITSTABLE, Kent, CT5 2AN	0.35 miles
	Hsbc Bank Plc, 135 Tankerton Road, WHITSTABLE, Kent, CT5 2AW	0.39 miles
	Barclays Bank Plc, East Kent Group, WHITSTABLE, Kent, CT5 1AU	0.56 miles
DIY Stores		Approx Distance
	B & Q Plc, Thanet Way, WHITSTABLE, Kent, CT5 3QS	1.06 miles
	Storers Stores, 96 Herne Bay Road, WHITSTABLE, Kent, CT5 2LX	1.23 miles
	Homebase Ltd, Eddington Way, HERNE BAY, Kent, CT6 5UJ	3.64 miles
	Baydis Ltd, 7 William Street, HERNE BAY, Kent, CT6 5EW	4.02 miles
	Parker Tools, Vauxhall Ind Road, CANTERBURY, Kent, CT1 1HD	5.37 miles
Hotels		Approx Distance
	The Marine Hotel - Shepherd Neame Pubs, Marine Parade, WHITSTABLE, Kent, CT5 2BE	0.36 miles
	Travelodge, A299, FAVERSHAM, Kent, ME13 9EL	3.27 miles
	Premier Inn, Margate Road, HERNE BAY, Kent, CT6 6LA	4.61 miles
	Travelodge, A2 Trunk Road, FAVERSHAM, Kent, ME13 9LN	5.25 miles
	Victoria Hotel, 59 London Road, CANTERBURY, Kent, CT2 8JY	5.55 miles
Theatres / Concert Halls		Approx Distance
	Playhouse Theatre, 104 High Street, WHITSTABLE, Kent, CT5 1AZ	0.59 miles
	The Marlowe Theatre, The Friars, Canterbury, Kent, CT1 2AS	5.79 miles
	Arden Theatre, Leslie Smith Drive, FAVERSHAM, Kent, ME13 8PW	7.11 miles
	Sheppey Little Theatre, Meyrick Road, SHEERNESS, Kent, ME12 2NX	12.87 miles
	Theatre Royal, Addington Street, Margate, Kent, CT9 1PW	15.11 miles

**Disclaimer:** The information represented in this section has been sourced from Experian and is based on the property's postcode.



	Cinemas	Approx Distance
	Kavanagh Cinema, William Street, HERNE BAY, Kent, CT6 5NX	3.94 miles
	Gulbenkian Cinema, Gulbenkian Theatre, CANTERBURY, Kent, CT2 7NB	4.54 miles
	Odeon Cinemas Ltd, 45 St Georges Place, CANTERBURY, Kent, CT1 1UP	6.17 miles
	The Royal Cinema, 9 Market Place, FAVERSHAM, Kent, ME13 7AG	7.04 miles
	Carlton Cinema, 29 St. Mildreds Rd, Westgate-on-Sea , Kent, CT8 8RE	12.98 miles
	Leisure Centres	Approx Distance
	Waterfront, Beach Walk, WHITSTABLE, Kent, CT5 2BP	0.32 miles
	Whitstable Sports Centre, Bellevue Road, WHITSTABLE, Kent, CT5 1PX	0.67 miles
	Active Life Ltd, Amphenol Complex, WHITSTABLE, Kent, CT5 3JF	0.89 miles
	Herons Leisure Centre, William Street, HERNE BAY, Kent, CT6 5NX	3.94 miles
	The University Of Kent, University of Kent at, CANTERBURY, Kent, CT2 7NZ	4.55 miles
	Newsagents	Approx Distance
	The Chocolate Box, 53 Old Bridge Road, WHITSTABLE, Kent, CT5 1RB	0.26 miles
	Harbour News, 43 Harbour Street, WHITSTABLE, Kent, CT5 1AH	0.56 miles
	Oxford News, 29 Oxford Street, WHITSTABLE, Kent, CT5 1DB	0.65 miles
	Ron Willis, 86 Herne Bay Road, WHITSTABLE, Kent, CT5 2LX	1.23 miles
	Cycling World, Crown House, WHITSTABLE, Kent, CT5 3BJ	2.79 miles
	Post Offices	Approx Distance
	Post Office Ltd, Gladstone Road, WHITSTABLE, Kent, CT5 1AA	0.54 miles
	Seasalter Post Office, 118 Joy Lane, WHITSTABLE, Kent, CT5 4ES	1.68 miles
	Sea Street Post Office, 111 Sea Street, HERNE BAY, Kent, CT6 8QX	3.2 miles
	Post Office Within Co-operative Food, 160 Mortimer Street, HERNE BAY, Kent, CT6 5DU	4.16 miles
	Herne Village Stores, 18 Herne Street, HERNE BAY, Kent, CT6 7HQ	4.18 miles

**Disclaimer:** The information represented in this section has been sourced from Experian and is based on the property/s postcode.



**Charles Bainbridge** 1 The Bakery 47 Broad Street, Canterbury, CT1 2LS **01227 780227**



Everything you want  
to know about  
local policing



### Understanding who polices your neighbourhood

When you move to a new area, you want to know the arrangements for local community policing. See below for essential information about police services near to **28 Castle Road**. We have included location and contact details for the police station and wherever possible, details of police officers assigned to the area.

### Your policing neighbourhood

The name of your policing neighbourhood is **Canterbury - Harbour** and it has a population of **5641**.

Harbour ward in Canterbury is an urban area with more than 3,000 households.

#### Your Local Policing Team

Name	Rank	Tel No.	E-mail
Jade Hoyle	PCSO	101	
Barton	Sergeant	101	
Vicki Tyler	Inspector	101	
Jack Roy	PCSO	101	
Chloe Tydeman	PCSO	101	

**Disclaimer:** The information represented in this section has been sourced from data.police.uk.

### Locations of Interest

Canterbury Police Station  
 station  
 Old Dover Road, Canterbury

9am - 5pm every day (excluding bank holidays)

**Disclaimer:** The information represented in this section has been sourced from data.police.uk.



**Charles Bainbridge** 1 The Bakery 47 Broad Street, Canterbury, CT1 2LS **01227 780227**



Everything you want  
to know about  
*your community*



**Understanding the demographics of the local community**

Census statistics can be used to build up a detailed snapshot of the population and its composition. We can see how the population is differentiated by age, employment status, education, and so on at a particular point in time. In this section we have extracted information specific to the local area for **28 Castle Road** and compared it with information for all citizens of the UK so that you can better understand the character of your prospective local community.

The below tables allow you to make a comparison between your prospective local vicinity (Output Area), County and National results. An Output Area is the lowest geographical level that census statistics are provided. They are formed from adjacent postcodes with the minimum size being 40 residential households up to a recommended size of 125 households. Urban/rural mixes are avoided where possible.

**Age Profile**

The below table provides an age breakdown of the local population which will help give you an understanding of how your prospective new area's age distribution compares against the county and national average.

	Output Area	Kent	National
0-4	6.23% (19)	5.88% (78234)	5.96% (2926238)
5-14	15.74% (48)	13.25% (176173)	12.93% (6351576)
15-24	9.18% (28)	11.35% (150934)	12.18% (5985323)
25-34	12.79% (39)	12.75% (169556)	14.36% (7054271)
35-44	14.1% (43)	14.59% (193995)	14.94% (7341900)
45-54	11.8% (36)	13.74% (182706)	13.22% (6494262)
55-64	12.13% (37)	11.29% (150060)	10.54% (5177261)
65-74	6.89% (21)	8.86% (117815)	8.35% (4102841)
75-84	7.87% (24)	6.1% (81084)	5.6% (2751135)
>85	3.28% (10)	2.19% (29161)	1.94% (954024)

## Education Profile

The below table provides an education breakdown of the local population which will help give you an understanding of how your prospective new area's educational profile compares against the county and national average. The levels used are designed as:

- **Level 1** - 1-4 O Levels/CSE/GCSEs (any grades), Entry Level, Foundation Diploma, NVQ level 1, Foundation GNVQ, Basic/Essential Skills
- **Level 2** - 5+ O Level (Passes)/CSEs (Grade 1)/GCSEs (Grades A\*-C), School Certificate, 1 A Level/2-3 AS Levels/VCEs, Intermediate/Higher Diploma, Intermediate Diploma, NVQ level 2, Intermediate GNVQ, City and Guilds Craft, BTEC First/General Diploma, RSA Diploma Apprenticeship
- **Level 3** - 2+ A Levels/VCEs, 4+ AS Levels, Higher School Certificate, Progression/Advanced Diploma, NVQ Level 3; Advanced GNVQ, City and Guilds Advanced Craft, ONC, OND, BTEC National, RSA Advanced Diploma
- **Level 4+** - Degree (for example BA, BSc), Higher Degree (for example MA, PhD, PGCE), NVQ Level 4-5, HNC, HND, RSA Higher Diploma, BTEC Higher level, Foundation degree, Professional qualifications (for example teaching, nursing, accountancy)

	Output Area	Kent	National
None	18.0% (36)	28.33% (268478)	28.85% (10251674)
Level 1	14.5% (29)	18.21% (172579)	16.63% (5909093)
Level 2	29.0% (58)	21.01% (199159)	19.36% (6877530)
Level 3	5.0% (10)	7.96% (75416)	8.34% (2962282)
Level 4 or 5	25.5% (51)	16.77% (158974)	19.9% (7072052)
Unknown	8.0% (16)	7.73% (73224)	6.92% (2459460)

**Disclaimer:** The information represented in this section has been sourced from The Office for National Statistics.

## Employment Profile

The below table provides an employment breakdown of the local population which will help give you an understanding of how your prospective new area's employment compares against the county and national average.

	Output Area	Kent	National
Employee part time	10.4% (21)	12.43% (117796)	11.81% (4196041)
Employee full time	45.05% (91)	40.4% (382965)	40.81% (14499241)
Self employed part time	1.98% (4)	2.24% (21251)	1.95% (694033)
Self employed full time	5.45% (11)	7.12% (67454)	6.36% (2260955)
Unemployed	2.48% (5)	2.8% (26582)	3.35% (1188855)
Full time students	1.98% (4)	2.35% (22260)	2.58% (917582)
Student	3.47% (7)	3.79% (35943)	4.67% (1660564)
Retired	18.81% (38)	14.69% (139198)	13.54% (4811595)
Looking after home family	6.44% (13)	7.19% (68147)	6.52% (2316229)
Permanently sick/disabled	2.48% (5)	4.36% (41313)	5.3% (1884901)
Other	1.49% (3)	2.63% (24921)	3.1% (1102095)

**Disclaimer:** The information represented in this section has been sourced from The Office for National Statistics.



